

PROPERTY MAPS  
TOWN OF LYMAN, MAINE

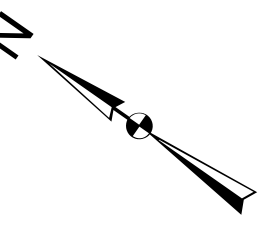

James H. Thomas  
gisSolutions of Maine  
Cumberland, Maine  
jht@maine.rr.com

These maps are intended to be used for the purpose of Property Tax Assessments and should not be used for conveyances.  
Revised to April 1st

Scale: 1 Inch = 600

- Hooks
- Matchline
- FSW
- Streams
- TownBoundary
- Shore
- Subject Map
- Bordering Map
- Bordering Map
- Bordering Map
- Bordering Map

2020

MAP: 03

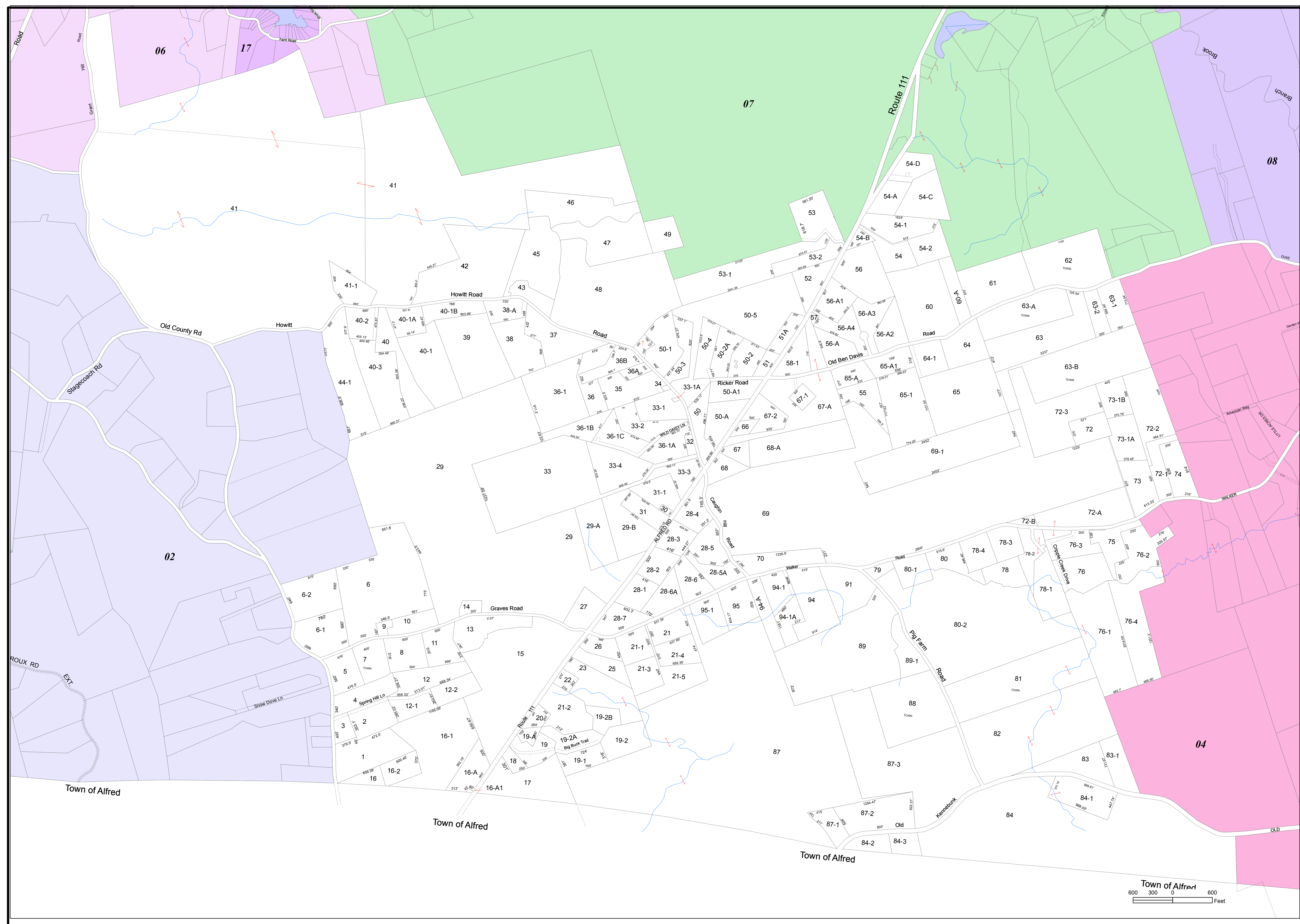

Town of Alfred  
600 300 0 600 Feet